

# Fiat Scudo



LIGHT COMMERCIAL VEHICLES





---

## **Professional style.**

There's a big difference between working and working in style, and it's called the Fiat Scudo. Dependable, powerful and nimble, the Scudo makes an impressive calling card and projects a truly professional image. From the front, innovative, eye catching light clusters, a streamlined bonnet and wraparound bumper hint at dynamic prowess, efficiency and strength. Deep side mouldings complement the Scudo's balanced, sturdy proportions. At the rear, clean, square lines maximise space for goods.





---

## **A perfect place to work.**

For early starts and long days, you need the comfort, quality and equipment of the Fiat Scudo. The driving position has been carefully created with ergonomically designed seat, backrest and height adjustment, height and reach adjustable steering wheel, fascia mounted gear lever and crystal clear instruments. A host of standard technology helps to make your day run smoothly, including electric adjustable wing mirrors. The cabin features driver's airbag, two seats, as well as electric windows and remote CD/radio controls on the steering wheel.





## Easy around town, effortless on long journeys.

The 120 MultiJet engine delivers sparkling performance, refinement and response. Tough and reliable, it makes the Scudo comfortable, economical and environmentally friendly. The 120 MultiJet gives you a balance of flexible performance and low running costs with smooth power on demand.

### MULTIJET TECHNOLOGY

#### 120 MultiJet

Engine capacity 1997 cm<sup>3</sup>  
 88 kW (120 bhp)  
 at 4000 rpm  
 300 Nm (30.6 kgm)  
 at 2000 rpm  
 Common Rail electronically controlled  
 direct injection with fixed geometry  
 turbocharger and intercooler  
 EURO 4  
 6 speed gearbox



#### Maintenance programme

**15,000 KM OIL**  
**30,000 KM SERVICE**

# Scudo van. Where business grows.

With 6m<sup>3</sup> of cargo space and 1200kg payload, the Scudo is a benchmark for load capacity. The space is equipped with eight cargo retaining hooks, and can be accessed through the sliding side doors or the full height double hinged rear doors. With the side doors providing a 92.4cm opening and the rear opening to a full 180 degrees, you can use every last centimetre of room for easy loading and storage. Fitted with hinged rear doors that feature heated rear window with wiper.



## Long wheelbase standard roof

### DIMENSIONS LOAD AREA AND DOORS

Load bay height	1449
Width	1600
Length	2584
Width between wheel arches	1245
Height of load floor	from 562 to 604 with mechanical suspension from 491 to 500 with air suspension
Sliding door width x height	924 x 1293
Rear door width x height	1237 x 1272



### Load bay volume

**6m<sup>3</sup>**

*Two fold out cup holders on the driver and passenger sides.*



### Load capacity

**1200 KG**



*Three spacious compartments can be found in the ceiling.*

## Versions and equipment.

### Panelled Long Wheelbase Van



#### Comfort version

Payload: 1200 kg  
Engine: 120 MultiJet  
Load space volume: 6m<sup>3</sup>



#### Comfort version

Black bumper  
Black wing mirrors  
Black side mouldings



#### Comfort version

Hinged rear doors with windows  
Black bumper  
Black hinge covers

---

## Making light of your load.

The Scudo makes handling and loading packages of every shape and size effortless, because with air suspension fitted, the cargo floor is just 495mm from the ground. An optional feature available at the touch of a button located in the load space.

*A control in the load compartment lets you raise and lower the loading height.*

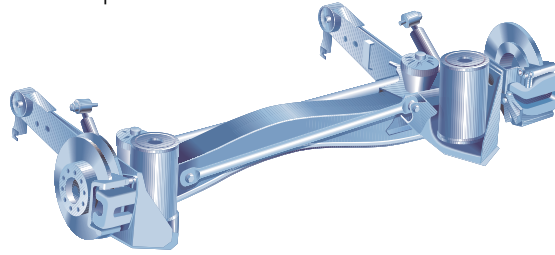

*Air suspension lowers the loading floor for easy cargo handling and loading, but it also offers maximum comfort for passengers and better stability, even when your load is stowed unevenly.*

---

## Seriously safe.

Studies, research, road tests and crash tests have all helped to make the Scudo uncompromisingly safe, with the latest solutions and technology providing leading edge protection for occupants. Passengers are fully protected by a rigid safety cell and programmed crumple zones.

Active safety is exceptional, thanks to a very stiff bodyshell and sophisticated suspension for stability in all conditions. Braking is failsafe with standard ABS and EBD. An additional standard feature on the Scudo is HBA, a system that boosts braking force in an emergency.

Every seat is equipped with an adjustable headrest and three-point seatbelt and every model has a driver airbag as standard.



*Powerful ventilated front disc brakes.*



*Smooth, precise six speed gearbox.*

*A four dial instrument cluster feature graphics on a black background for ultimate legibility.*



*Seatbelts with pretensioner and load limiter.*



# Body colours and upholstery.

## Pastel colours.

194 Nizza Red



249 White



455 Imperial Blue



## Metallic colours.

453 Lake Blue



506 Golden White



685 Aluminium Grey



691 Slate Grey



### Body colours / upholstery combinations.

#### Pois Blue Fabric 148

##### Pastel

194	Nizza Red	
249	White	
455	Imperial Blue	

##### Metallic

453	Lake Blue	
506	Golden White	
685	Aluminium Grey	
691	Slate Grey	

## Upholstery.

148 Pois Blue Fabric



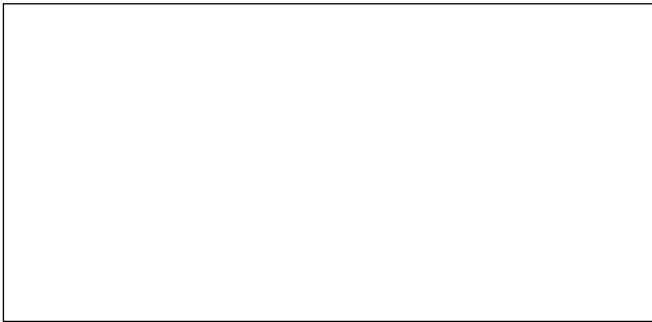

**Fiat Automotive Australia,  
Locked Bag 260, Silverwater, NSW 1811  
☎ 1800 003 428**

Performance figures supplied by Fiat SpA.

Ateco Automotive Pty Ltd trading as FIAT Australia reserves the right to discontinue or change the models, features, specifications, options, designs and prices of the products referred to in this brochure without incurring any liability whatsoever to any purchaser or prospective purchaser of any such products. Some of the items herein are optional at extra cost. Consult your Fiat Dealer for the latest information on models, specifications, features, prices, options and availability. ABN 34 000 486 706. Printing date: April 2008. Part no. 272.001.

© 2008 Fiat Commercial Vehicles Australia  
Heritage Building, Campus Business Park  
350 Parramatta Road, Homebush NSW 2140 Australia  
Telephone +61 2 9701 8033 Facsimile +61 2 9701 3533

**[www.fiat.com.au](http://www.fiat.com.au)**

